

BILDA® Thermal Insulation (outside) fixing method

- Fixes insulation to the substructure
- Presses insulation to the outside cladding
- Lower cost of fastening materials
- No thermal bridges
- No damage to outside wall
- Minimum damage to insulation - allows reuse

- Unique & best method for retrofit of the dry wall
- Fixes fire barriers to substructure
- Ultimate fire resistance



SUSTAINABLE



QUICK & EASY



LOW COST



HIGHLY RECOMMENDED

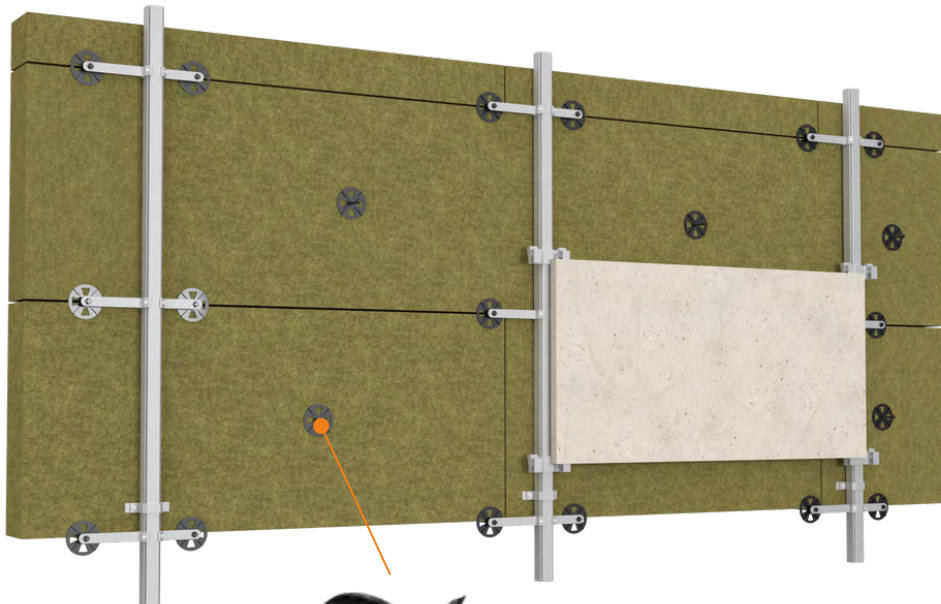

01

INSULATION SPACER

- Presses insulation against the cladding panels to avoid sagging of insulation

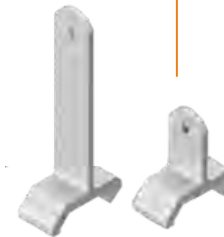

02

INSULATION YOKE

- Fixes the supporting insulation anchor to the substructure

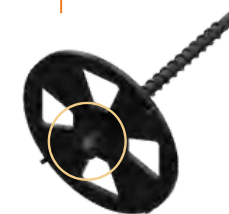

03

SUPPORTING INSULATION ANCHOR

- Supports & presses the insulation against the primary structure, without a direct connection



BILDA® Fire stop fixing method

Fixing methods for fire barriers in ventilated façade

